

Precautions on use

- This product is for invitro diagnostic use only.
- Do not drink the preservative solution contained in the stool collection tube.
- Do not remove or swallow beads in the stool collection tube.
- Care must be taken to avoid contact with the preservative solution with the skin or eyes.
- If the preservative solution comes into contact with the skin or eyes, it should be washed immediately with running water.
- Be careful not to injure your hands when opening and closing the lid.
- When closing the lid, make sure to close it tightly to prevent the contents from spilling out.
- When you go to the toilet, make sure that urine does not penetrate the stool collection paper.
- When placing the sample into the stool collection tube, do not insert any material other than the stool, such as toilet paper.
- Do not collect stool after diarrhea or taking bowel cleansers.
- Please do not reuse this product as it is a single-use only product.
- Use the product under the direction of a medical professional.

Other product-related matters

- This product is a medium used for the transport and preservation of specimens for the purpose of diagnosing diseases. The product is used for collecting, transporting, and storing human stool samples.
- This product is a kit that can collect one specimen, and the stool collection tube includes 20 mL of preservative solution.
- Store the product at room temperature.
- The expiry date of this product is 18 months from the date of manufacture. Do not use products past the expiry date.
- Product Assembly

Serial no.	Component	Quantity
1	Stool Collection Tube	1 EA
2	Stool Sampling Tool	1 EA
3	Instructions for Use	1 EA
4	Label Card	1 EA
5	Stool Collection Tube Collection Bag	1 EA
6	Disposal Bag	1 EA
7	Stool Collection Paper	1 EA



This product is an In vitro diagnostic medical device.

As it is a single-use only product, its reuse is prohibited.

Stool Collection Kit II Instructions for Use (SC02-3)

Be sure to read the precautions on use.

Stool Collection Kit II, Specimen transport media, SC02-3 / Product License No. IVD-21-427

Manufacturer: Genomictree, Inc. / www.genomictree.com

34027, 44-6 Techno 10-ro (Tamnip-dong), Yuseong-gu, Daejeon, Republic of Korea

GT-SC02-UM-703(RO) / TEL: +82-42-861-4551 / FAX: +82-42-861-4552 / E-mail: help.sg@genomictree.com

Step 1: Check the product components.

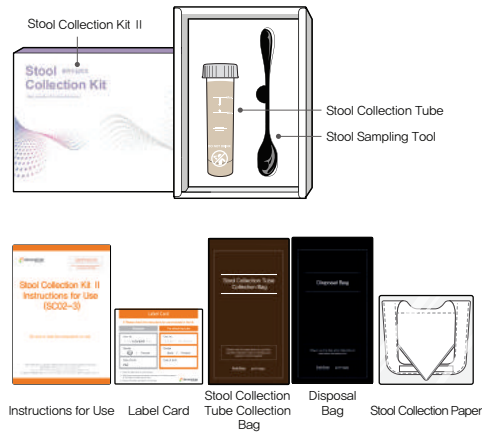

Check whether all components of the product are present.

- ① Stool Collection Tube
- ② Stool Sampling Tool
- ③ Instructions for Use
- ④ Label Card
- ⑤ Stool Collection Tube Collection Bag
- ⑥ Disposal Bag
- ⑦ Stool Collection Paper

Step 2: Stool collection preparation



Prepare a stool collection tube, stool sampling tool, disposal bag, and stool collection paper to collect stool from the bathroom.

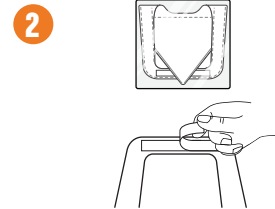

Peel off the white, adhesive tape from both ends of the stool collection paper.

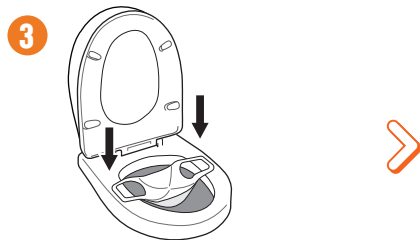

Raise the toilet cover or bidet cover and attach the stool collection paper in a slightly stretched shape to the upper surfaces of both sides of the toilet, as shown in the picture.



After confirming that the stool collection paper is well fixed, lower the cover and relieve yourself.

Step 3: Stool collection

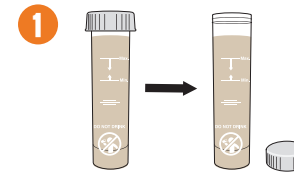

Prepare a stool collection tube. Open the lid and place it on a flat surface to avoid falling.

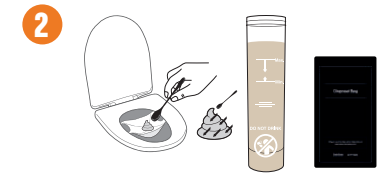

Using a stool sampling tool, place the stool in the collection tube so that the preservation solution is between the Min and Max lines marked on the collection tube. Collect stool by scraping it from at least 4–5 different surfaces. Be sure to follow the instruction for accurate inspection. After collecting stool, put the stool sampling tool in a disposal bag.

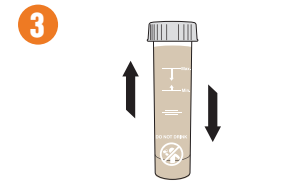

After collecting stool, close the lid tightly to prevent the contents from spilling out and shake it up and down several times to disperse the stool into the solution.



After collecting stool, flush the stool collection paper and stool down the toilet.

Step 4: Attaching label

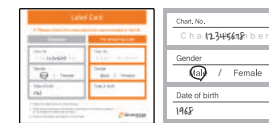

Prepare the label card enclosed inside and state the consent management number, gender, and year of birth on the label.



Attach the label to the stool collection tube.

Step 5: Submit the stool collection tube.



Put the stool collection tube in a collection bag and submit it to the hospital as soon as possible.